

# JBC

[www.jbctools.com](http://www.jbctools.com)



# MS

ELECTRIC  
DESOLDERING PUMP

# MS/ELECTRIC DESOLDERING PUMP

**MS-A**  
DESOLDERING PUMP



**0780637**  
CONNECTION CABLE



**MANUAL**



**0821830**  
SUCTION FILTER SET



**0005966**  
50 FILTERS BOX



**0781046**  
SPARE COTTON FILTERS

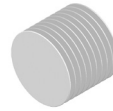

## INSTALLATION

**MS-A**  
DESOLDERING PUMP

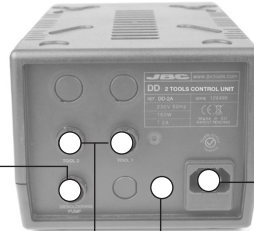

**DD-2B**  
CONTROL UNIT

Connectable control units:  
**DI, DD and DM.**

Connectable singles line:  
**DS**

Power Cord  
Socket

Equipotential  
connection

**DR560-A**  
DESOLDERING IRON



**DR-SC**  
DESOLDERING  
STAND

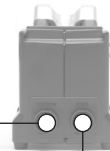

## ELECTRIC DESOLDERING PUMP ELEMENTS



## CHANGING PUMP FILTERS

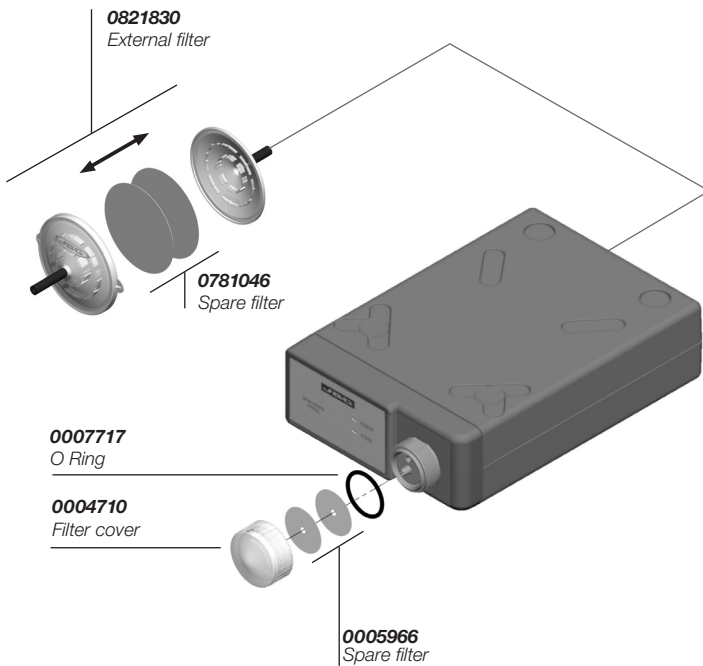

## TECHNICAL SPECIFICATIONS

---

- Supply: 24V.
- Power: 12W.
- Weight of complete unit: 1,2 Kgs.
- Complies with CE standards on electrical safety, electromagnetic compatibility and ESD protected housing "skin effect".
- RoHS compliant.
- Equipotential connector and the tool tip are connected to station mains ground supply for ESD protection.



This product should not be thrown in the garbage.

# JBC

---

### WARRANTY

JBC's 2 years warranty guarantees this equipment against all manufacturing defects, covering the replacement of defective parts and all necessary labour.

Warranty does not cover product wear due to use or mis-use.

In order for the warranty to be valid, equipment must be returned, postage paid, to the dealer where it was purchased enclosing this fully filled in, sheet.

---

SERIAL N°

---

STAMP OF DEALER

---

---

DATE OF PURCHASE

---

**[www.jbctools.com](http://www.jbctools.com)**

0008796-0712